



DC Inverter
Reversible

Airwell

XDOW

Water-cooled console

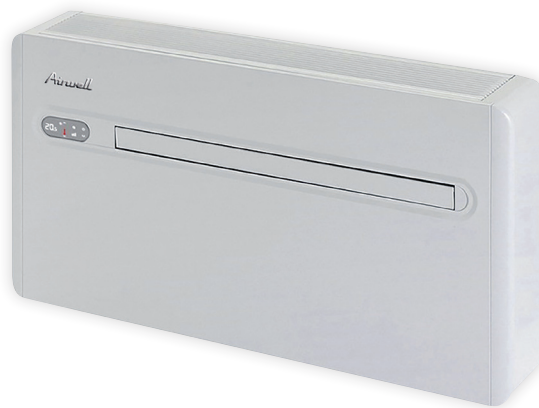

Optimal comfort:
reversible solution

+ PRODUCT

- Solution without outdoor unit
- Monoblock
- Simple design
- Quiet (25 dB)

TECHNICAL DRAWS

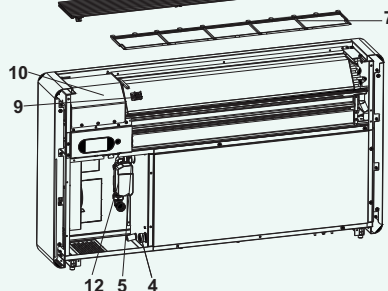
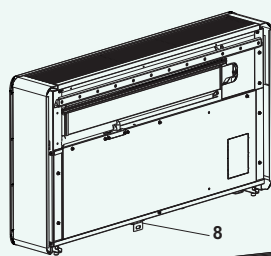
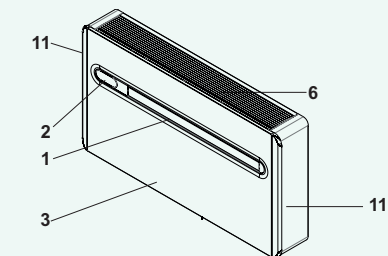

N°	DESCRIPTION
1	• Ventilation flap
2	• Control touchscreen
3	• Front panel
4	• Water inlet (Eurokonus M 3/4")
5	• Water outlet (Eurokonus M 3/4")
6	• Air intake grille
7	• Air filter
8	• Anti-uplift fastening
9	• Ambient temperature sensor
10	• Switch box
11	• Side panel
12	• Modulating valve (water side)

+ "SUSTAINABLE DEVELOPMENT"

> Reduced water consumption thanks to the built-in modulating valve.

+ "USER"

- > Compact.
- > Quiet.
- > Ideal solution for historic buildings (monoblock).

+ "INSTALLER"

> Plug & Play: hydraulic connection only.

+ "TECHNOLOGY"

> Compatible with water-loop and public water supply.

TECHNICAL DATA

INDOOR UNIT		XDOW-025R-01M25	XDOW-035R-01M25
Part number		7MB070001	7MB070002
Phase		Single-phase	Single-phase
COOLING			
Rated power (1)	kW	2.50	3.50
Pdesignc	kW	2.30	3.20
Rated power input	kW	0.38	0.76
EER/Energy label		4.08/A++	4.05/A++
Operating limits	°C	18°/35°	
Maximum water temperature	°C	40°C	
HEATING			
Rated power (2)	kW	2.70	3.80
Pdesignh	kW	2.50	3.40
Rated power input	kW	0.71	1.09
COP/Energy label		4.33/A++	4.31/A++
Operating limits	°C	5°/27°	
Minimum water temperature	°C	7°C	
INDOOR UNIT			
Sound pressure level to 2 m	dB(A)	25	27
Sound level (LS/MS/HS)	dB(A)	41/46/52	43/48/54
Airflow (LS/MS/HS)	m³/h	250/310/385	310/410/435
Recycled water flow	l/h	430	600
Wastewater flow (15°C)	l/h	107	150
Dehumidification	l/h	1.10	1.30
Compressor type		Rotary DCI	Rotary DCI
Outline dimensions (WxHxD)	mm	1030x555x165	1030x555x165
Package dimensions (WxHxD)	mm	1100x660x260	1100x660x260
Net weight/Gross weight	kg	48.5/50.5	49.5/51.5
POWER SUPPLY			
Phase/Voltage/Frequency		1P/220-240V/50Hz	1P/220-240V/50Hz
Power supply side		Indoor	Indoor
Power cable section	mm²	3x1.5	3x1.5
Fuse rating am (D curve)	A	6	6
PIPE LINE			
Refrigerant/GWP		R410A/2088	R410A/2088
Charge	kg	0.65	0.65

(1) Conditions: Dry bulb 27°C - Wet bulb 19°C - Water at 30°C ΔT 5K.
(2) Conditions: Dry bulb 20°C - Wet bulb 15°C - Water at 15°C ΔT 5K.