

SERVICE MANUAL

PORTABLE AIR CONDITIONER

AELIA 9A
AELIA 12A

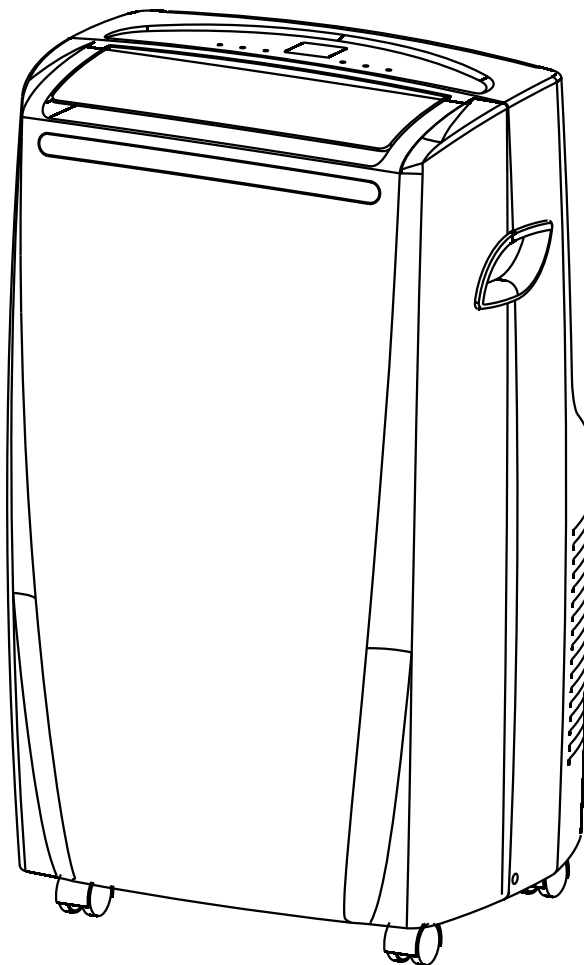

Important points on service, and flow chart for inspecting and repairing the unit.....	1
Appearance(out ward).....	2
Troubleshooting.....	3
Control panel.....	4
Remote control.....	5
Technical specifications.....	6-7
Refrigerator system diagram and schematic wiring diagram.....	8
Exploded view and parts list.....	9 -17

This manual is for the use of technical personnel entrusted with maintenance.

AIRWELL reserves the right to change this dehumidifier's casing, circuit and parts without notice.

220-240V / 50Hz

IMPORTANT POINTS ON SERVICE OPERATING SAFETY

Please follow these instructions carefully:

- Unplug the unit to avoid any danger from electric shock before disassembling the unit for repair.
- If there is any sound of the refrigerant circulating when in operation, avoid touching the cooling coils.
- If you need to perform any welding or soldering, be sure you are in a well ventilated area.
- Only a qualified professional should perform any welding on the unit.
- When repairing the unit, the specifications listed in this manual must be strictly adhered to when replacing any components.
- When replacing any electrical components they should be factory approved units.
- Be sure that any electrical components are properly wired and in place.

FLOW CHART FOR INSPECTING AND REPAIRING THE UNIT

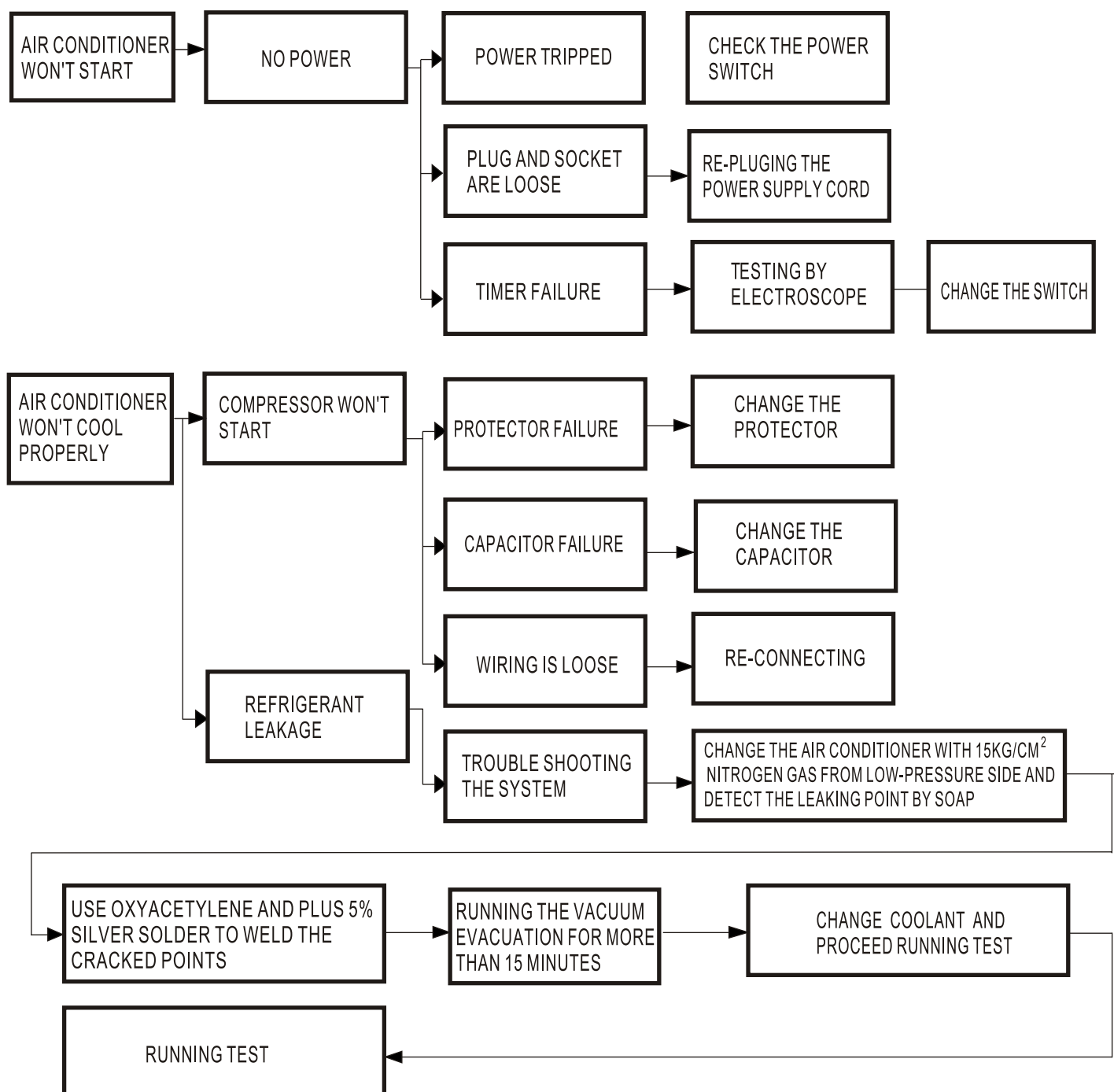

APPEARANCE

FRONT SIDE

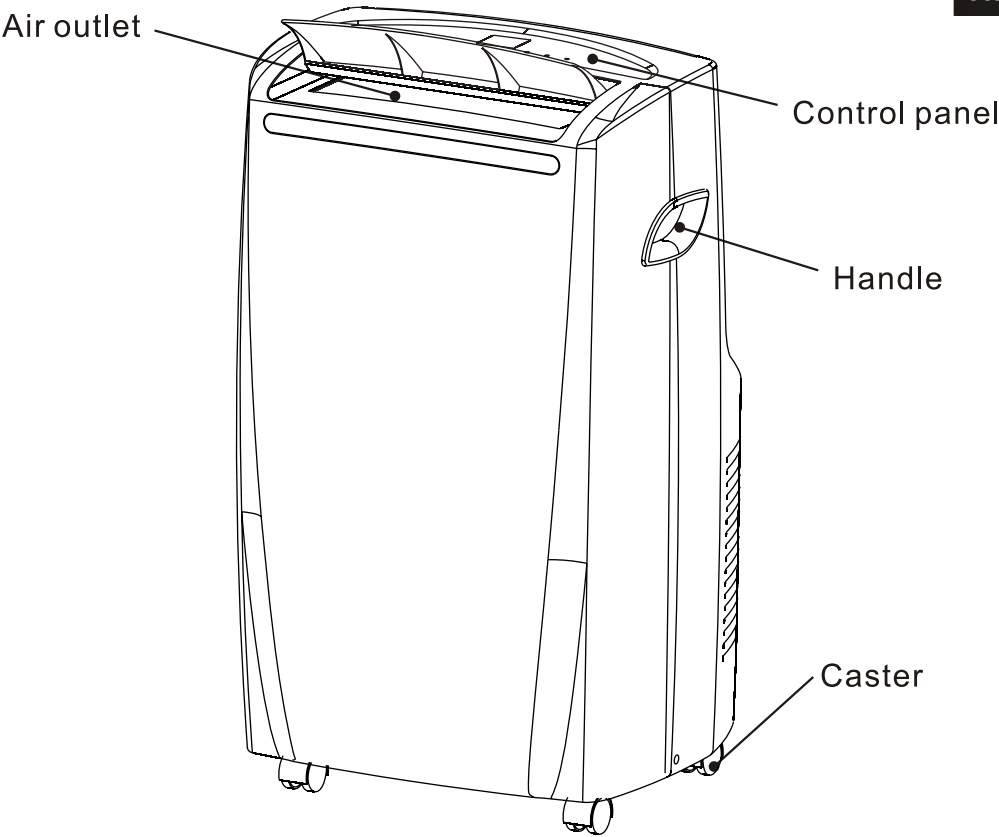

APPEARANCE (Single Tube)

BACK SIDE

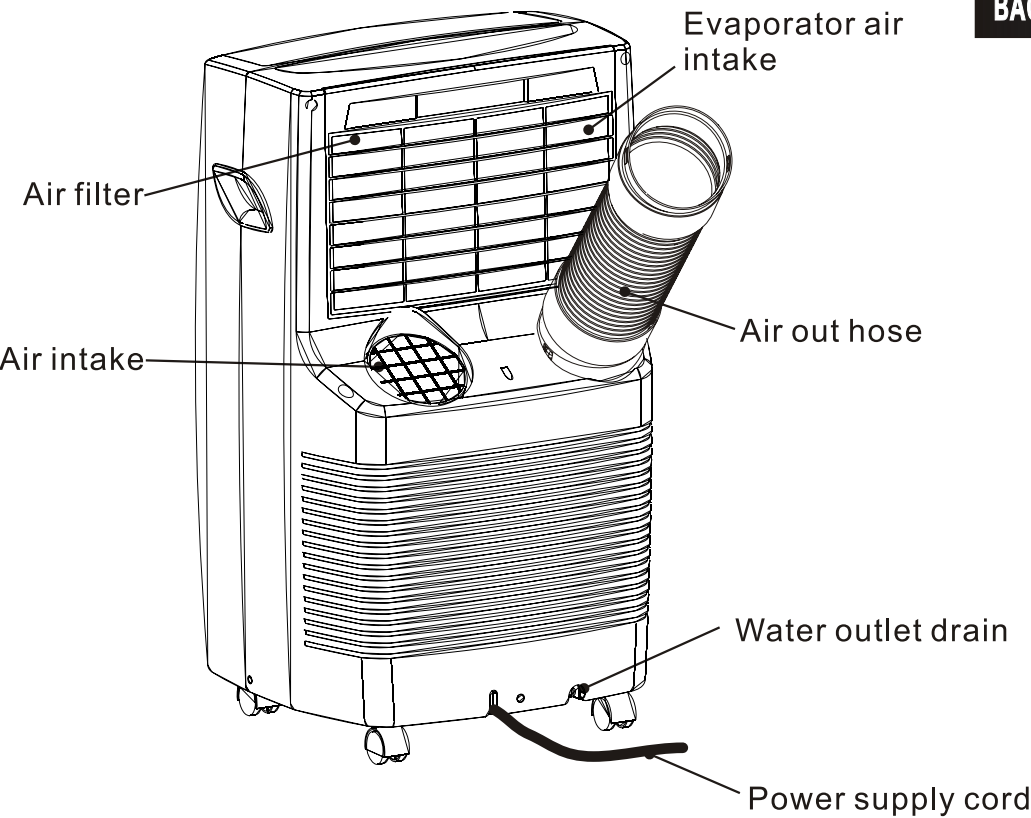

APPEARANCE (Two Tube)

BACK SIDE

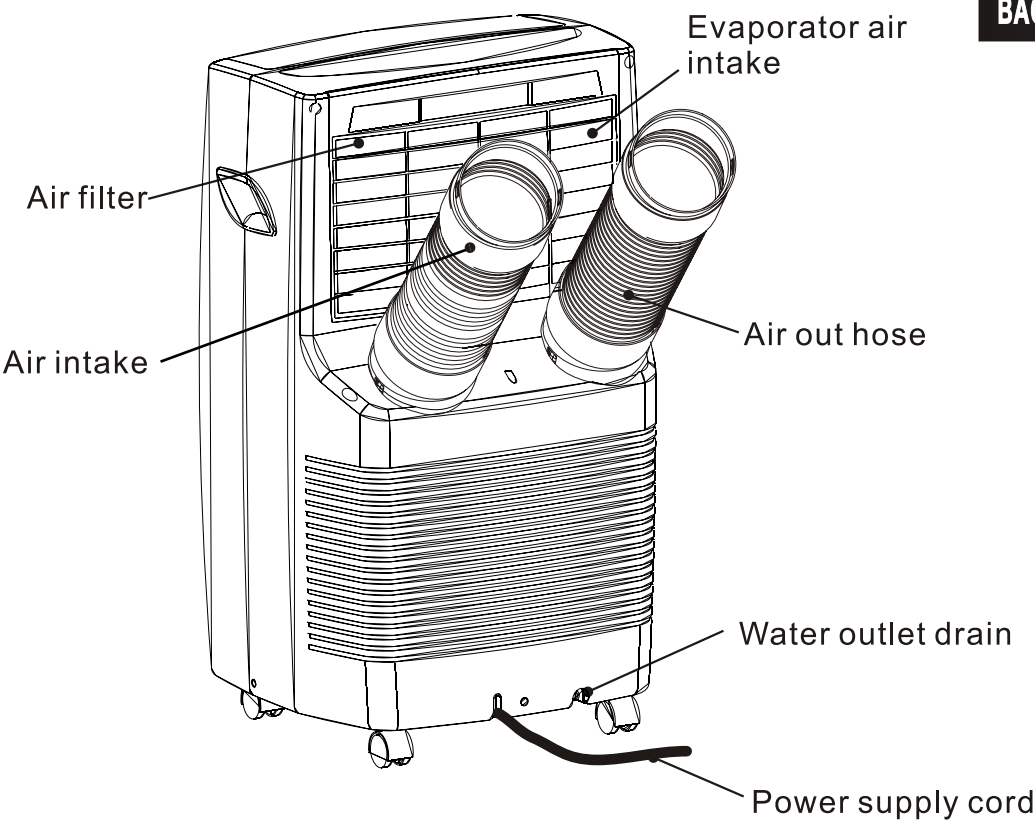

TROUBLE SHOOTING

The following cases may not always be a malfunction, please check it before asking for service.

Trouble	Analysis
Does not run	<ul style="list-style-type: none">·If the protector tripped or fuse is blown.·Please wait for 3 minutes and start again, protector device may be preventing unit to work.·If batteries in the remote controller exhausted.·If the plug is not properly plugged.
Stop during unit runs	<ul style="list-style-type: none">·If the set temperature is close to room temperature, you can low the set temperature.·Air outlet be blocked by obstacle. Take the obstacle away.
Run but not cool	<ul style="list-style-type: none">·If the door or window opened.·If there is other heater appliance working, like heater or lamp, etc...·The air filter is dirty, please clean it.·Air outlet or intake be blocked.·Set temperature is too high.
Do not run and water full indicator lights	<ul style="list-style-type: none">·Drain the water into a prepared container by the drainage pipe on the rear panel of the unit. If still doesn't work, please consult a qualified technician.

CONTROL PANEL

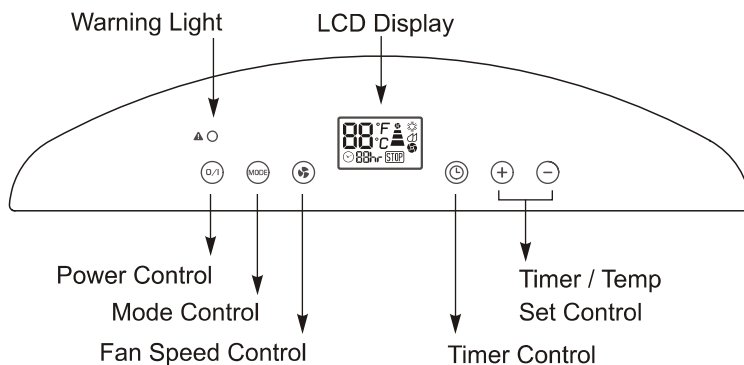

Indication symbols on LCD :

- Cooling mode
- Dehumidify mode
- Fan only mode
- Display set temperature
- Warning light the machine will stop running
- Display timer setting of auto switch on/off
- High fan speed
- Med fan speed
- Low fan speed

Power Control

The power control turns the unit on and off.

Warning Light

Condensed water may accumulate in the unit. If the internal tank becomes full, the Warning signal in the LCD Display will light up and the unit will not operate until the unit has been drained.

Mode Control

The Mode Control has 3 settings:

● Cool ● Dehumidify ● Fan

The settings are adjusted with Mode Control button. A light will indicate which setting is currently being used.

● Cooling Mode

When cool mode is selected, "❄" will show in the LCD Display. During the cooling mode the air is cooled and hot air is exhausted to the outside through the exhaust tube. Adjust fan speed and air temperature to suit your desired comfort level.

Note : The air exchange hoses must vent outside the room when using cool mode.

● Dehumidify Mode

When Dehumidify mode is selected, "☁" will show in the LCD Display. Air is dehumidified as it passes through the unit, without being in full cooling mode. If room temperature is higher than 25°C, fan speed can be adjusted; otherwise fan speed is fixed to "Low".

Note : If the unit is to be used as a dehumidifier, do not connect the exhaust hose let the warm air return to the room. Continuous drainage is then necessary.

● Fan Mode

When fan mode is selected, "🌀", "🌀" or "🌀" will be shown in the LCD Display, air is circulated throughout the room with no cooling.

Note: unit does not need to be vented in Fan mode

Fan Speed Control

The Fan Speed Control has 3 settings: High, Medium, and Low.

Timer

Auto turn off :

With machine in running mode, press timer button for setting timer control. Press "+" or "-" to select number of hours you would like the unit to run before it automatically shuts off.

Auto turn on :

With machine in stand by mode, press timer button for setting timer control. Press "+" or "-" to select number of hours before the unit automatically starts running in airconditioning mode.

Note : The time is adjustable between 1~24 hours.

Temperature controls

- Used for adjusting the thermostat.
 - The default display is room temperature.
 - In cooling mode, when "+" or "-" button is pressed, the set temperature is displayed and may be adjusted. After 15 seconds the display will revert back to room temperature. Temperature is only adjustable in cool mode.
- Note : By pressing both "+" / "-" buttons at the same time for more than 3 seconds, the display will toggle between Celsius and Fahrenheit.**

After switching the air conditioner off, you must wait 3 minutes before switching it back on again.

REMOTE CONTROL

Air Conditioner Remote Control

The functions work the same as your air conditioner's touch controls.
All key function can be accessed from the remote control.

CONTROL PANEL

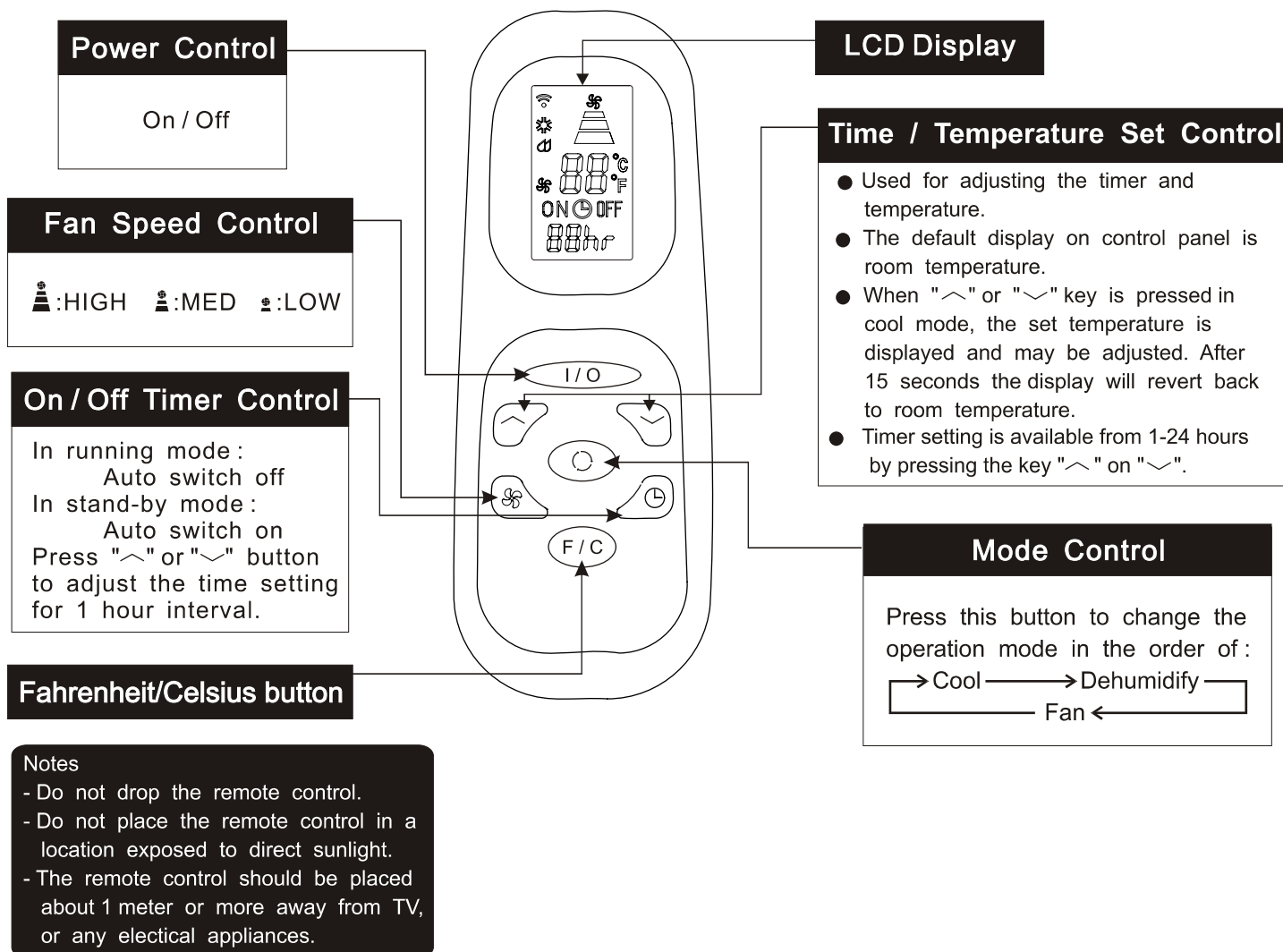

Battery replacement : Remove the cover on the back of the remote control and insert the batteries with the (+) and (-) poles pointing in the proper direction.

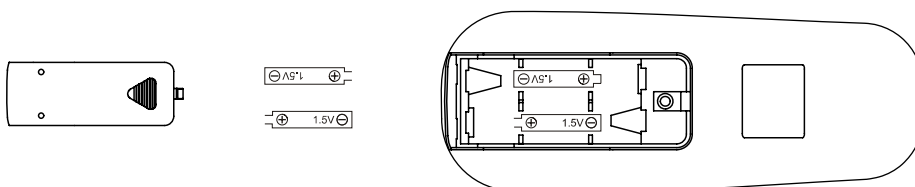

CAUTION

Use only AAA or IEC R03 1.5V batteries.

Remove the batteries if the remote control is not used for a month or longer.

Do not attempt to recharge the supplied batteries.

All batteries should be replaced at the same time, do not mix old battery .

Do not dispose of the batteries in a fire as they may explode.

TECHNICAL SPECIFICATIONS

AIR CONDITIONER

ITEM		UNIT	AELIA 9A
OUTER DIMENSION		mm	510W * 830H * 425D
REFERENTIAL USING AREA		m ²	13-19
RATED VOLTAGE		V/Hz	220-240 / 50
COOLING CAPACITY		B.T.U.	9000
DEHUMIDIFYING CAPACITY		L/H	1.6
RUNNING CURRENT		A	5.4
POWER CONSUMPTION		W	1000
INDOOR AIR VOLUME		m ³ /hr	320
COMPRESSOR	MODEL		NWT 44N087A1
	INPUT POWER	W	898
	OPERATING CYCLE	uF/V	25/450
	PROTECTOR		MRA12227-12082
	LOCKED ROTOR AMPS	A	4.13
INDOOR MOTOR	MODEL		LS-23D3-4P
	OUTPUT POWER	W	40
	OPERATING CYCLE	uF/V	1.5/450
OUTDOOR MOTOR	MODEL		LS-53D1-4P
	OUTPUT POWER	W	40
	OPERATING CYCLE	uF/V	4/450
TURBINE FAN MOTOR	MODEL		WT-10D1-01
	OUTPUT POWER	W	2
CAPILLARY		mm	D2.6Xd1.2XL700
EVAPORATOR			3R14S19FPI
CONDENSER			(2R17S+1R17S)19FPI
REFRIGERANT		R-410A/g	520
WEIGHT		Kg	35

TECHNICAL SPECIFICATIONS

AIR CONDITIONER

ITEM		UNIT	AELIA 12 A	
OUTER DIMENSION		mm	510W * 830H * 425D	
REFERENTIAL USING AREA		m ²	22-30	
RATED VOLTAGE		V/Hz	220-240 / 50	
COOLING CAPACITY		B.T.U.	12000	
DEHUMIDIFYING CAPACITY		L/H	2.0	
RUNNING CURRENT		A	6.4	
POWER CONSUMPTION		W	1400	
INDOOR AIR VOLUME		m ³ /hr	420	
COMPRESSOR	MODEL		NWT 44N110A1	Rechi 44A263A
	INPUT POWER	W	1166	1090
	OPERATING CYCLE	uF/V	35/400	35/370
	PROTECTOR		Inbuilt	B200-150B-141E
	LOCKED ROTOR AMPS	A	5.47	5.10
INDOOR MOTOR	MODEL		LS-23D3-4P	LS-23D3-4P
	OUTPUT POWER	W	40	40
	OPERATING CYCLE	uF/V	2/450	2/450
OUTDOOR MOTOR	MODEL		LS-53D1-4P	LS-53D1-4P
	OUTPUT POWER	W	40	40
	OPERATING CYCLE	uF/V	4/450	4/450
TURBINE FAN MOTOR	MODEL		WT-10D1-01	WT-10D1-01
	OUTPUT POWER	W	2	2
CAPILLARY		mm	D2.6Xd1.0XL700	D2.6Xd1.2XL850
EVAPORATOR			3R14S19FPI	3R14S19FPI
CONDENSER			(2R17S+2R17S)19FPI	(2R16S+2R17S)19FPI
REFRIGERANT		R-410A/g	800	880
WEIGHT		Kg	36	36

REFRIGERATOR SYSTEM DIAGRAM

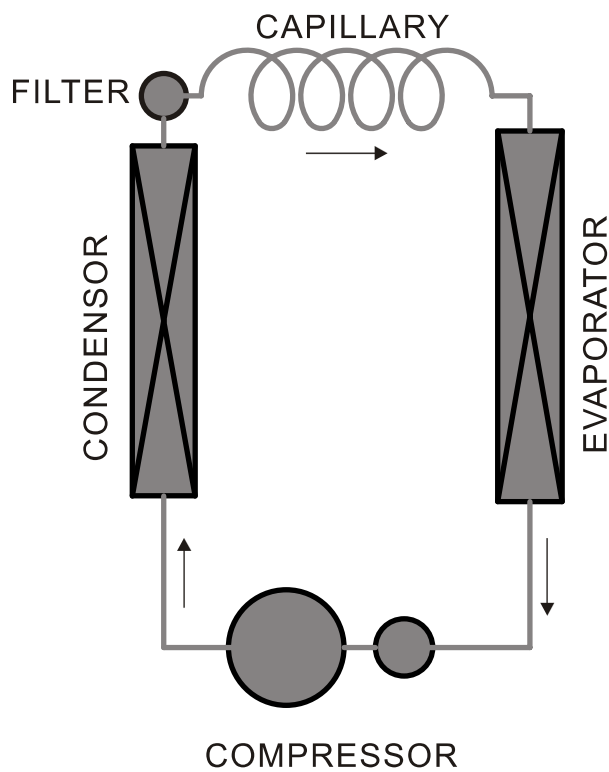

SCHEMATIC WIRING DIAGRAM

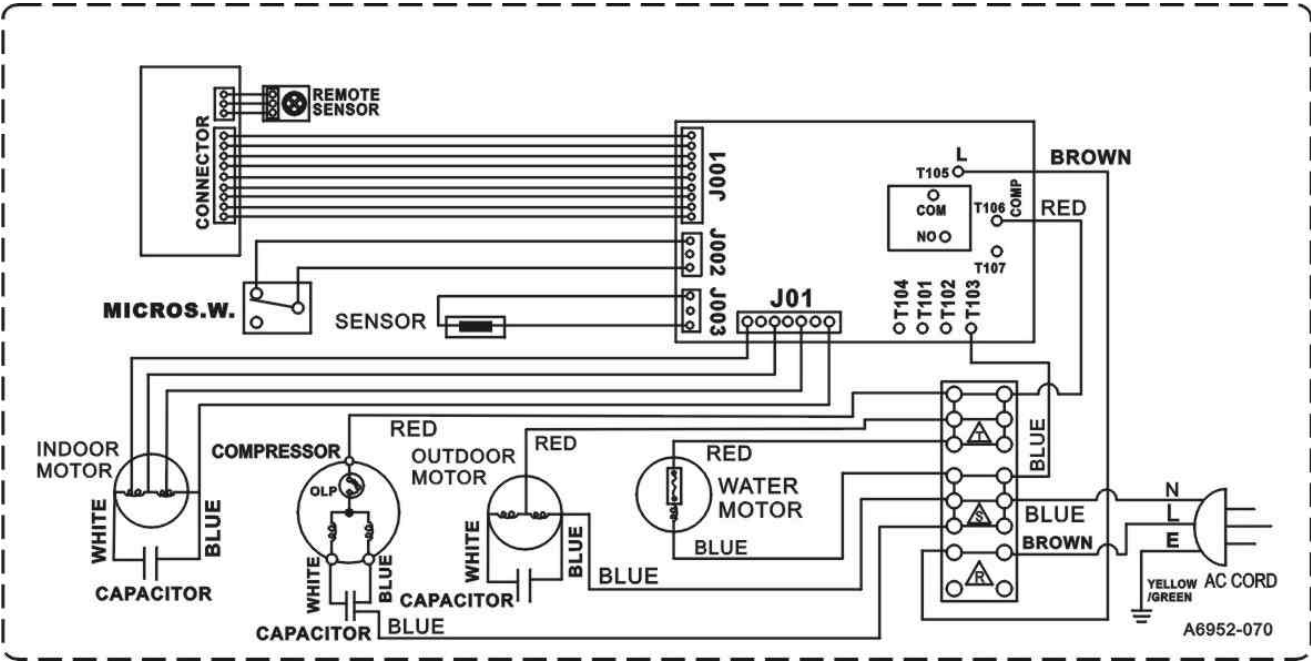

EXPLODED VIEW

AELIA 9 A

(NWT compressor)

ACCESSOR

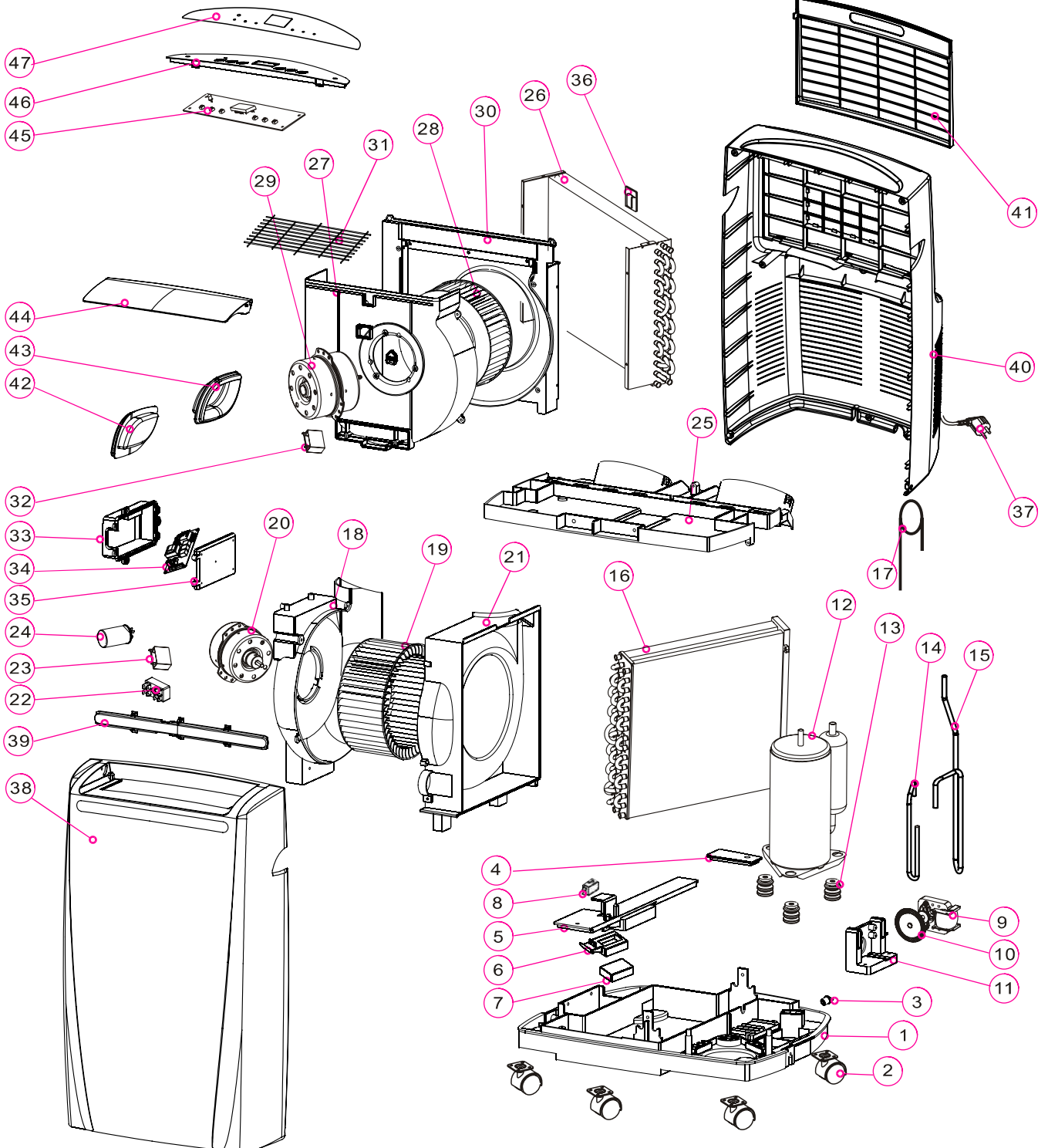
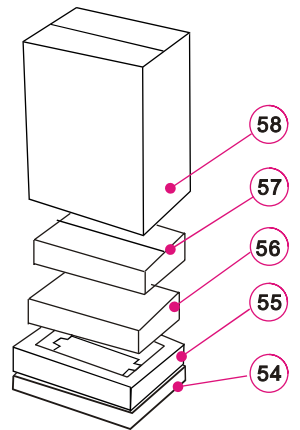
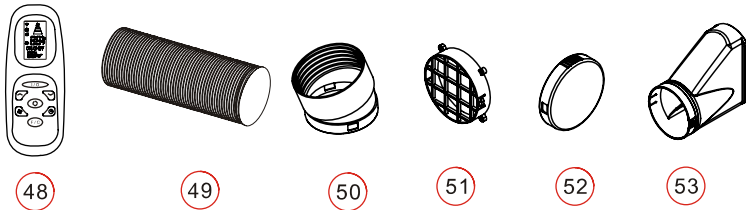

PARTS LIST

NO	MATERIAL CODE	PARTS NAME	QUANTITY	PRICE
1	A4805-210-A-11	BASE PAN	1	
2	A7402-020	TURNING WHEEL	4	
3	A7307-060	SOFT CAP	1	
4	A5408-250-H-11	DRAIN BUCKET COVER-B	1	
5	A5408-230-H-11	DRAIN BUCKET COVER-A	1	
6	A5405-110-H-11	FLOAT	1	
7	A5404-090	FLOAT	1	
8	A2506-020	MICRO SWITCH	1	
9	A3001-840	FAN MOTOR(WT-10D1-01)	1	
10	A5311-030-A-11	BLADE	1	
11	A5812-630-X-11	FIXTURE	1	
12	A3202-930	COMPRESSOR ASS'Y(44N087A1)	1	
13	A5600-170	RUBBER	3	
14	A6209-590	DISCHARGE PIPE	1	
15	A6228-760	SUCTION PIPE	1	
16	A3422-700	CONDENSER ASS'Y	1	
17	A6204-460	CAPILLARY	1	
18	A5301-610-AH-22	FAN CASING	1	
19	A5304-470-AH-11	BLOWER WHEEL	1	
20	A3002-460	FAN MOTOR(LS-53D1-4P)	1	
21	A5301-620-AH -22	FAN CASING	1	
22	A2525-020	TERMINAL BLOCK	1	
23	A2509-670	CAPACITOR(4uF/450V FOR FAN MOTOR(20))	1	
24	A2509-150	CAPACITOR(25uF/450V FOR COMPRESSOR(12))	1	
25	A5702-170-A-22	PLATE	1	
26	A3419-550	EVAPORATOR ASS'Y	1	
27	A5301-590-A-22	FAN CASING	1	
28	A5304-310-A-22	BLOWER WHEEL	1	
29	A3002-710	FAN MOTOR(LS-23D3-4P)	1	
30	A5301-730-A-22	FAN CASING	1	
31	A7204-040	SCREEN	1	
32	A2509-550	CAPACITOR(1.5uF/450V FOR FAN MOTOR(29))	1	
33	A6101-510-AF-11	COVER	1	
34	A2516-280	CONTROL BOARD	1	
35	A5812-570-AF-11	FIX TURE	1	

PARTS LIST

NO	MATERIAL CODE	PARTS NAME	QUANTITY	PRICE
36	A5812-540-P-11	FIX TURE	1	
37	A3700-320	POWER SUPPLY CORD COMPLETE	1	
38	A4201-730-A-BS	FRONT PANEL	1	
39	A4230-790-A-AK	DECORATING PLATE	1	
40	A4219-370-A-BS	REAR PANEL	1	
41	A7301-230-A-BS	AIR FILTER	1	
42	A4258-120-A-BS	HANDLE-R	1	
43	A4258-110-A-BS	HANDLE-L	1	
44	A4243-790-A-BS	VAN-AIR DEFLECTOR	1	
45	A2521-190	PC BOARD	1	
46	A4254-590-H-22	CONTROL PLATE	1	
47	A6930-010-J5	CONTROL PLANE	1	
48	A2529-430	REMOTE CONTROL ASS'Y	1	
49	A6200-070	HEAT EXHAUST HOSE	1	
50	A5815-090-H-BS	HEAT EXHAUST HOSE CONNECTOR	2	
51	A5812-210-H-BS	FIX TURE	1	
52	A6101-230-H-BS	COVER	1	
53	A4238-170-P-BS	DISCHARGE GRILLE	1	
54	A7105-550	TRAY	1	
55	A7108-690	SHOCK ABSORBER	1	
56	A7108-700	SHOCK ABSORBER	1	
57	A7010-730	CARTON	1	
58	A7010-620	CARTON	1	
59				
60				
61				
62				
63				
64				
65				
66				
67				
68				
69				
70				

EXPLODED VIEW

AELIA 12 A

(NWT compressor)

ACCESSOR

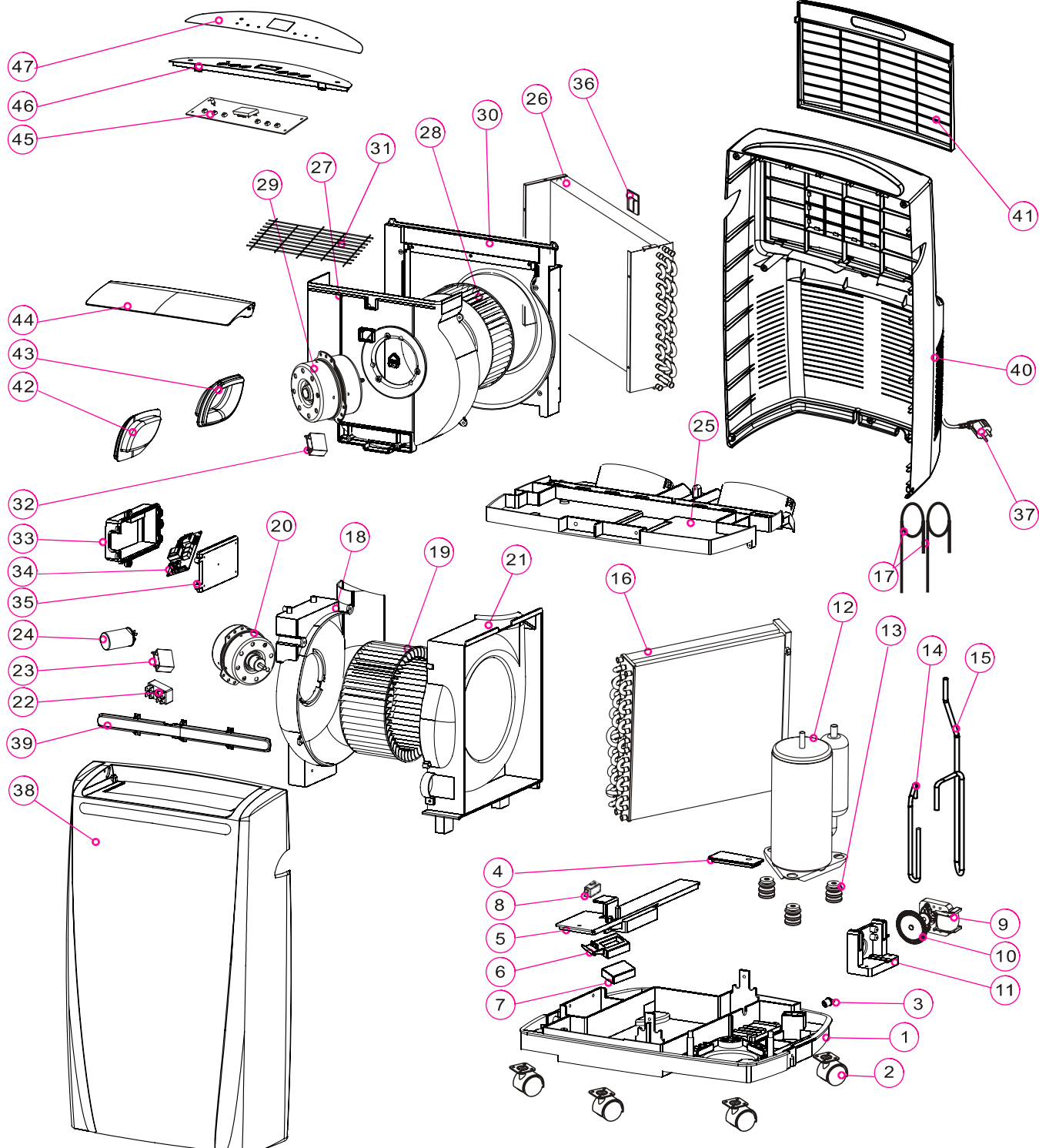
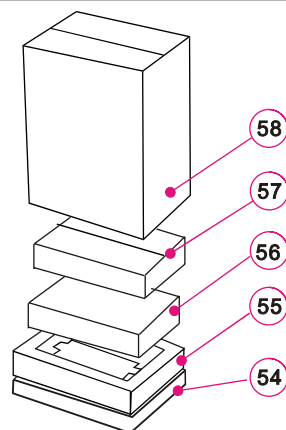
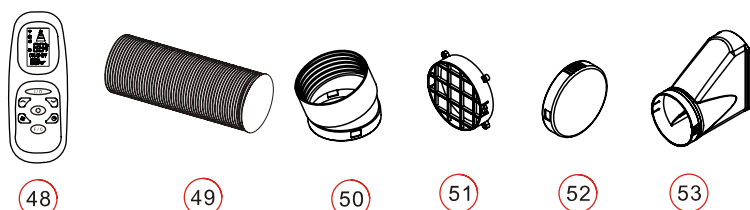

PARTS LIST

NO	MATERIAL CODE	PARTS NAME	QUANTITY	PRICE
1	A4805-210-A-11	BASE PAN	1	
2	A7402-020	TURNING WHEEL	4	
3	A7307-060	SOFT CAP	1	
4	A5408-250-H-11	DRAIN BUCKET COVER-B	1	
5	A5408-230-H-11	DRAIN BUCKET COVER-A	1	
6	A5405-110-H-11	FLOAT	1	
7	A5404-090	FLOAT	1	
8	A2506-020	MICRO SWITCH	1	
9	A3001-840	FAN MOTOR(WT-10D1-01)	1	
10	A5311-030-A-11	BLADE	1	
11	A5812-630-X-11	FIXTURE	1	
12	A3202-900	COMPRESSOR ASS'Y(44N110A1)	1	
13	A5600-170	RUBBER	3	
14	A6209-270	DISCHARGE PIPE	1	
15	A6228-300	SUCTION PIPE	1	
16	A3422-420	CONDENSER ASS'Y	1	
17	A6204-590	CAPILLARY	2	
18	A5301-610-AH-22	FAN CASING	1	
19	A5304-470-AH-11	BLOWER WHEEL	1	
20	A3002-460	FAN MOTOR(LS-53D1-4P)	1	
21	A5301-620-AH -22	FAN CASING	1	
22	A2525-020	TERMINAL BLOCK	1	
23	A2509-670	CAPACITOR(4uF/450V FOR FAN MOTOR(20))	1	
24	A2509-700	CAPACITOR(35uF/400V FOR COMPRESSOR(12))	1	
25	A5702-170-A-22	PLATE	1	
26	A3419-340	EVAPORATOR ASS'Y	1	
27	A5301-590-A-22	FAN CASING	1	
28	A5304-310-A-22	BLOWER WHEEL	1	
29	A3001-760	FAN MOTOR(LS-23D3-4P)	1	
30	A5301-730-A-22	FAN CASING	1	
31	A7204-040	SCREEN	1	
32	A2509-540	CAPACITOR(2uF/450V FOR FAN MOTOR(29))	1	
33	A6101-510-AF-11	COVER	1	
34	A2516-280	CONTROL BOARD	1	
35	A5812-570-AF-11	FIX TURE	1	

PARTS LIST

NO	MATERIAL CODE	PARTS NAME	QUANTITY	PRICE
36	A5812-540-P-11	FIX TURE	1	
37	A3700-320	POWER SUPPLY CORD COMPLETE	1	
38	A4201-730-A-BS	FRONT PANEL	1	
39	A4230-790-A-AK	DECORATING PLATE	1	
40	A4219-370-A-BS	REAR PANEL	1	
41	A7301-230-A-BS	AIR FILTER	1	
42	A4258-120-A-BS	HANDLE-R	1	
43	A4258-110-A-BS	HANDLE-L	1	
44	A4243-790-A-BS	VAN-AIR DEFLECTOR	1	
45	A2521-190	PC BOARD	1	
46	A4254-590-H-22	CONTROL PLATE	1	
47	A6930-010-J5	CONTROL PLANE	1	
48	A2529-430	REMOTE CONTROL ASS'Y	1	
49	A6200-070	HEAT EXHAUST HOSE	1	
50	A5815-090-H-BS	HEAT EXHAUST HOSE CONNECTOR	2	
51	A5812-210-H-BS	FIX TURE	1	
52	A6101-230-H-BS	COVER	1	
53	A4238-170-P-BS	DISCHARGE GRILLE	1	
54	A7105-550	TRAY	1	
55	A7108-690	SHOCK ABSORBER	1	
56	A7108-700	SHOCK ABSORBER	1	
57	A7010-730	CARTON	1	
58	A7010-620	CARTON	1	
59				
60				
61				
62				
63				
64				
65				
66				
67				
68				
69				
70				

EXPLODED VIEW

AELIA 12A

(Rechi compressor)

ACCESSOR

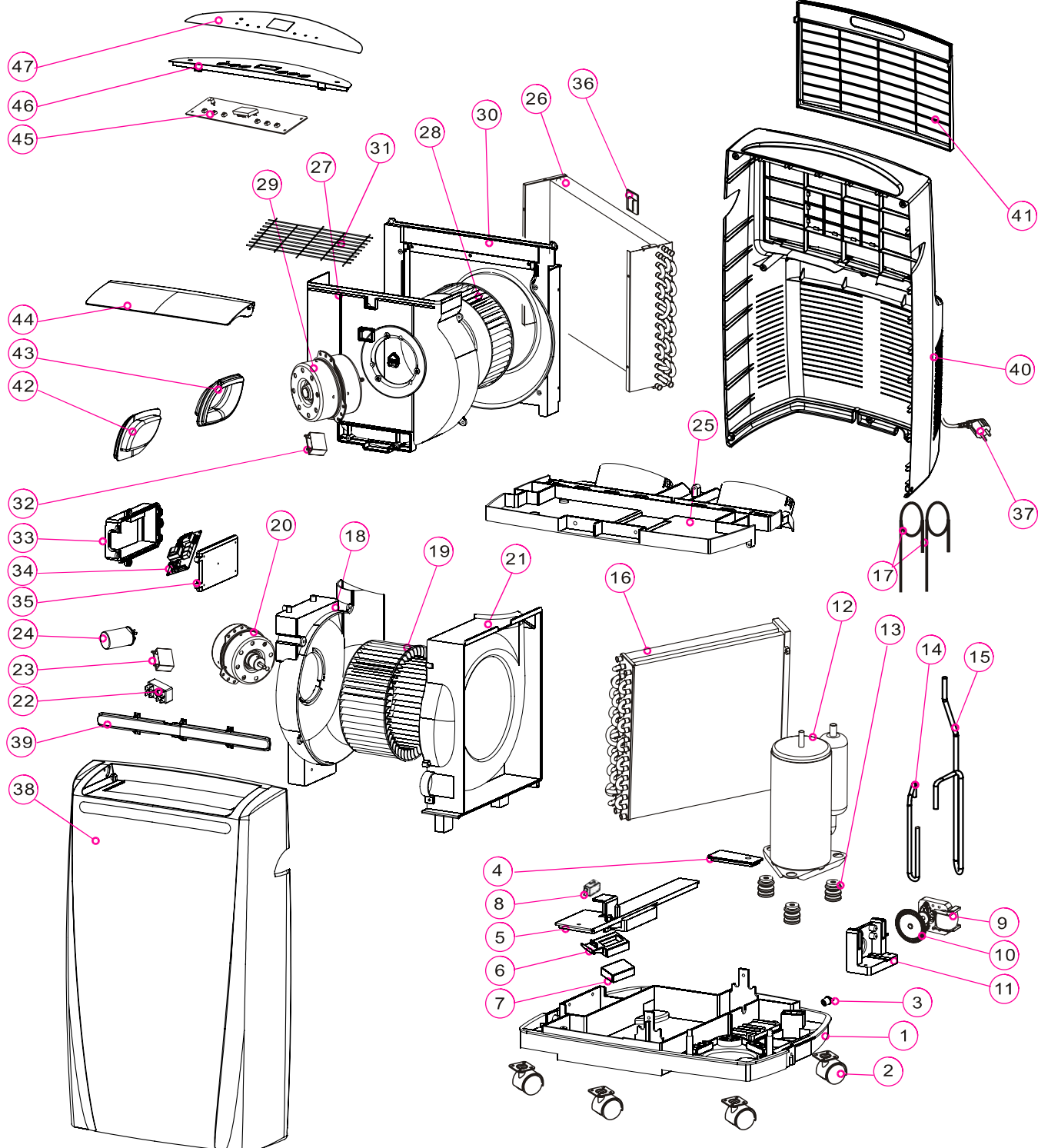
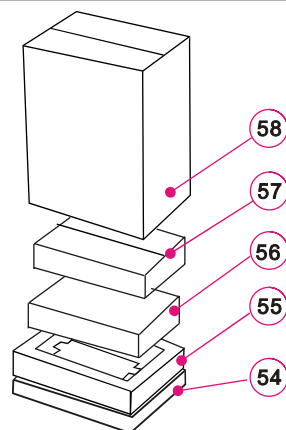
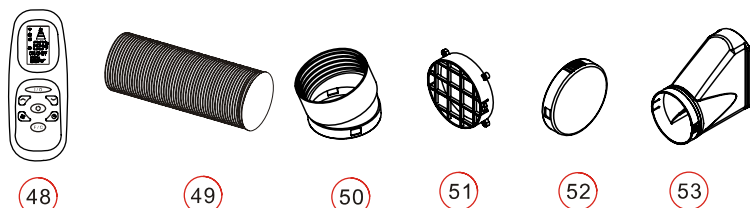

PARTS LIST

NO	MATERIAL CODE	PARTS NAME	QUANTITY	PRICE
1	A4805-210-A-11	BASE PAN	1	
2	A7402-020	TURNING WHEEL	4	
3	A7307-060	SOFT CAP	1	
4	A5408-250-H-11	DRAIN BUCKET COVER-B	1	
5	A5408-230-H-11	DRAIN BUCKET COVER-A	1	
6	A5405-110-H-11	FLOAT	1	
7	A5404-090	FLOAT	1	
8	A2506-020	MICRO SWITCH	1	
9	A3001-840	FAN MOTOR(WT-10D1-01)	1	
10	A5311-030-A-11	BLADE	1	
11	A5812-630-X-11	FIXTURE	1	
12	A3202-820	COMPRESSOR ASS'Y(44A263A)	1	
13	A5600-020	RUBBER	3	
14	A6209-050	DISCHARGE PIPE	1	
15	A6228-280	SUCTION PIPE	1	
16	A3422-350	CONDENSER ASS'Y	1	
17	A6204-550	CAPILLARY	2	
18	A5301-610-AH-22	FAN CASING	1	
19	A5304-470-AH-11	BLOWER WHEEL	1	
20	A3002-460	FAN MOTOR(LS-53D1-4P)	1	
21	A5301-620-AH -22	FAN CASING	1	
22	A2525-020	TERMINAL BLOCK	1	
23	A2509-670	CAPACITOR(4uF/450V FOR FAN MOTOR(20))	1	
24	A2509-040	CAPACITOR(35uF/370V FOR COMPRESSOR(12))	1	
25	A5702-170-A-22	PLATE	1	
26	A3419-340	EVAPORATOR ASS'Y	1	
27	A5301-590-A-22	FAN CASING	1	
28	A5304-310-A-22	BLOWER WHEEL	1	
29	A3001-760	FAN MOTOR(LS-23D3-4P)	1	
30	A5301-730-A-22	FAN CASING	1	
31	A7204-040	SCREEN	1	
32	A2509-540	CAPACITOR(2uF/450V FOR FAN MOTOR(29))	1	
33	A6101-510-AF-11	COVER	1	
34	A2516-280	CONTROL BOARD	1	
35	A5812-570-AF-11	FIX TURE	1	

PARTS LIST

NO	MATERIAL CODE	PARTS NAME	QUANTITY	PRICE
36	A5812-540-P-11	FIX TURE	1	
37	A3700-320	POWER SUPPLY CORD COMPLETE	1	
38	A4201-730-A-BS	FRONT PANEL	1	
39	A4230-790-A-AK	DECORATING PLATE	1	
40	A4219-370-A-BS	REAR PANEL	1	
41	A7301-230-A-BS	AIR FILTER	1	
42	A4258-120-A-BS	HANDLE-R	1	
43	A4258-110-A-BS	HANDLE-L	1	
44	A4243-790-A-BS	VAN-AIR DEFLECTOR	1	
45	A2521-190	PC BOARD	1	
46	A4254-590-H-22	CONTROL PLATE	1	
47	A6930-010-J5	CONTROL PLANE	1	
48	A2529-430	REMOTE CONTROL ASS'Y	1	
49	A6200-070	HEAT EXHAUST HOSE	1	
50	A5815-090-H-BS	HEAT EXHAUST HOSE CONNECTOR	2	
51	A5812-210-H-BS	FIX TURE	1	
52	A6101-230-H-BS	COVER	1	
53	A4238-170-P-BS	DISCHARGE GRILLE	1	
54	A7105-550	TRAY	1	
55	A7108-690	SHOCK ABSORBER	1	
56	A7108-700	SHOCK ABSORBER	1	
57	A7010-730	CARTON	1	
58	A7010-620	CARTON	1	
59				
60				
61				
62				
63				
64				
65				
66				
67				
68				
69				
70				

AIR CONDITIONER

Use and Care Manual

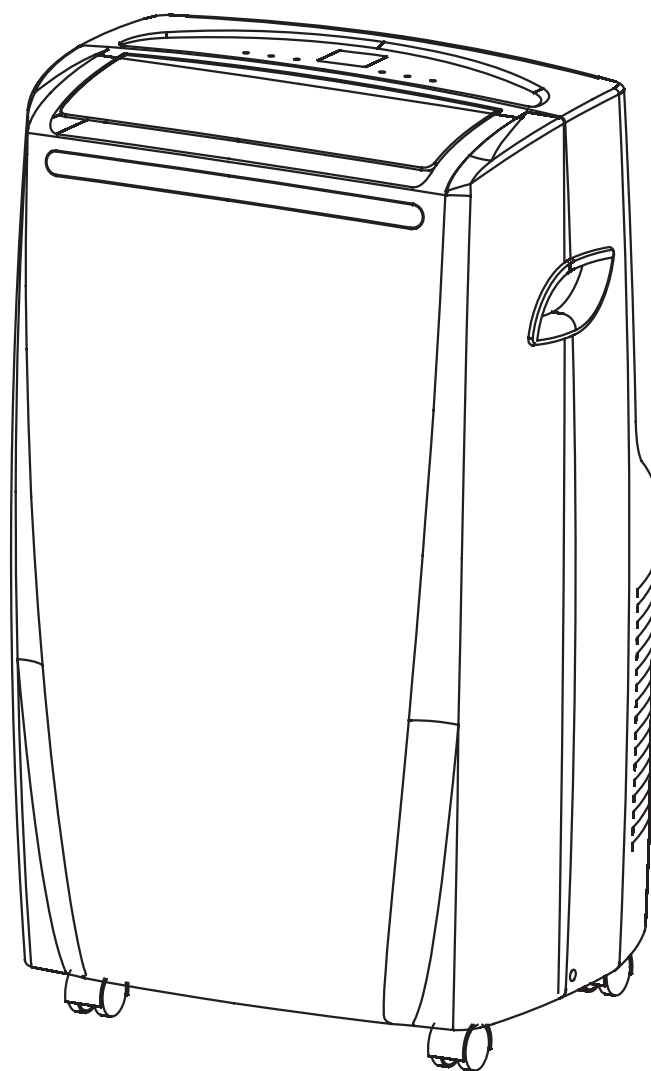

Introduction

Thank you for choosing this air conditioner to provide you and your family with all of the "Home Comfort" requirements for your home, apartment, or office. The appliance can be moved from room to room within your home and set up in just minutes.

This is a multi-functional room air-exchanging, air-processing appliance, designed to offer you the functions of: Air Conditioning, Dehumidifying, heating (for heating mode only) and Independent Fan.

This manual will provide you with valuable information necessary for the proper care and maintenance for your new appliance. Please take a few moments and read the instructions thoroughly. If properly maintained, your appliance will give you many years of trouble free operation.

Electrical Specifications

1. All wiring must comply with local and national electrical codes and be installed by a qualified electrician. If you have any questions regarding the following instructions, contact a qualified electrician.
2. Check available power supply and resolve any wiring problems before installation and operation of this unit.
3. For your safety and protection, this unit is grounded through the power cord plug when plugged into a matching wall outlet. If you are not sure whether the wall outlets in your home are properly grounded, please consult a electrician. Do not use plug adapters or extension cords with this unit.

Warning

Improper handling can cause serious damage to the appliance.
Read this manual carefully before operating the unit.

Do not wet the housing or control panel.



Do not cover the air outlet while in use.



Do not allow children to play with the controls or drop any objects into the air outlet.



Do not place objects or let any person sit on top of the unit.



Always turn the unit off and remove the power plug from the socket when cleaning.



Remove the plug from the socket if the unit is not being used for a long period of time.



Use only the correct power supply AC220-240V/50Hz



Do not attempt to remove any part of the casing unless by a authorized technician.



Do not operate the unit with a damaged plug or loose socket point.



Make sure that the back of the unit is at least 10cm or more from a wall.
Do not place the unit in front of curtains or drapes incase they fall against the back air intake.

Rout the power cord carefully to avoid a tripping hazard.

WARNING

- If the power cord on this unit is damaged it must be replaced by the manufacturer, its service agent or qualified persons in order to avoid a hazard .
- This appliance is not intended for use by children or other persons without assistance or supervision if their physical, sensory or mental capabilities prevent them from using it safely. Children should be supervised to ensure that they do not play with the appliance.
- This appliance is intended for domestic use only, any other use may invalidate the warranty and might be dangerous.

Identification of parts

Identification of parts

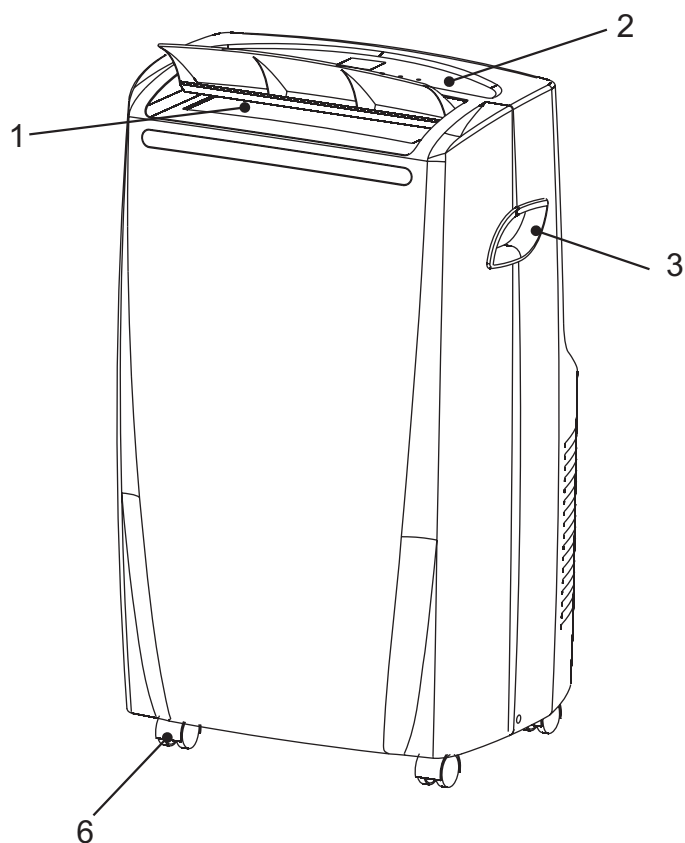

1. Air outlet

2. Control panel

3. Handle hole

4. Air inlet

5. Air outlet hose

6. Casters

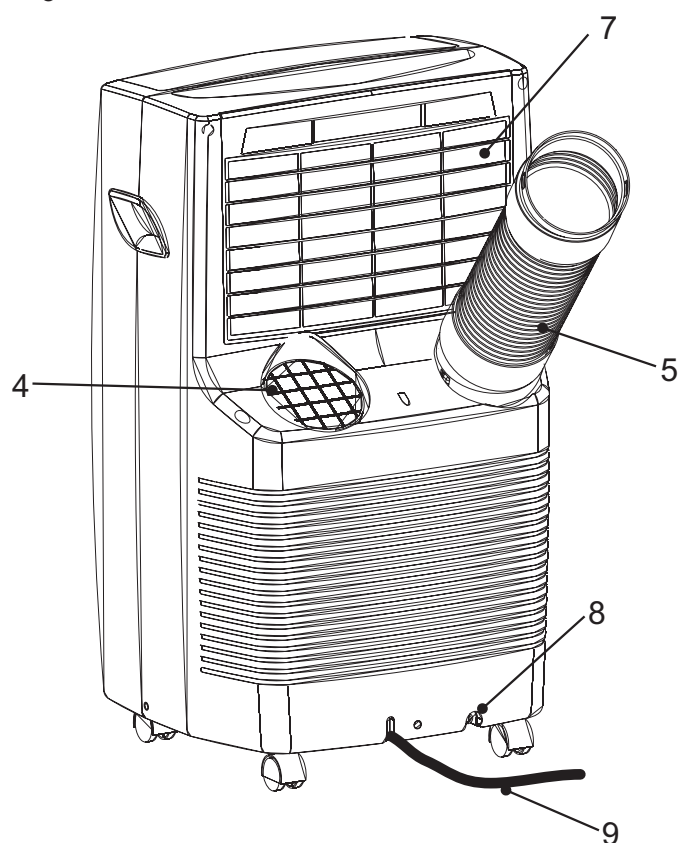

7. Air intake (Evaporator)

8. Water outlet drain

9. Power supply cord

OUTLINE DIMENSIONS

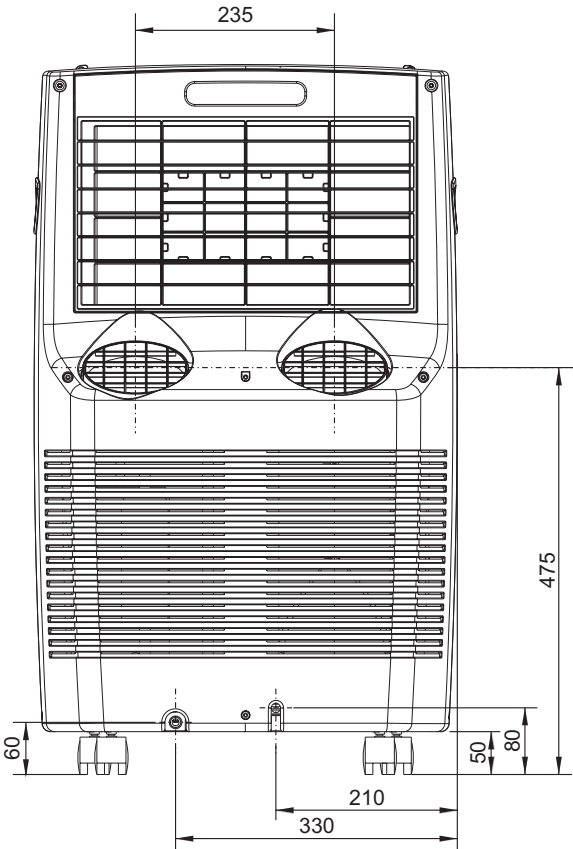
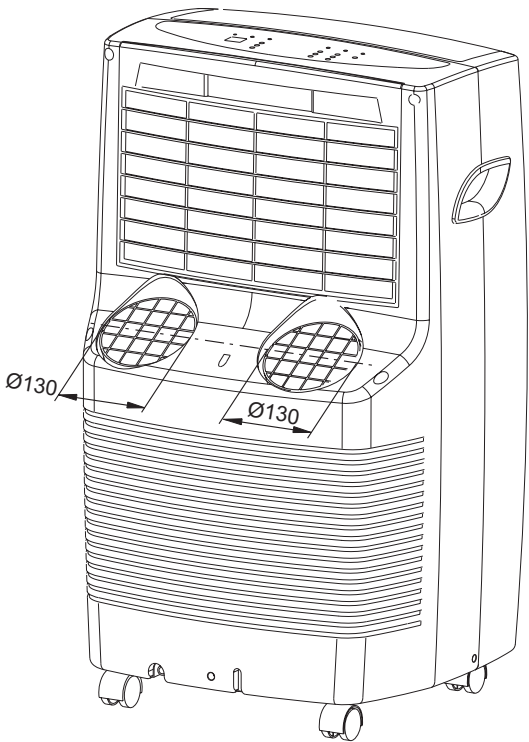
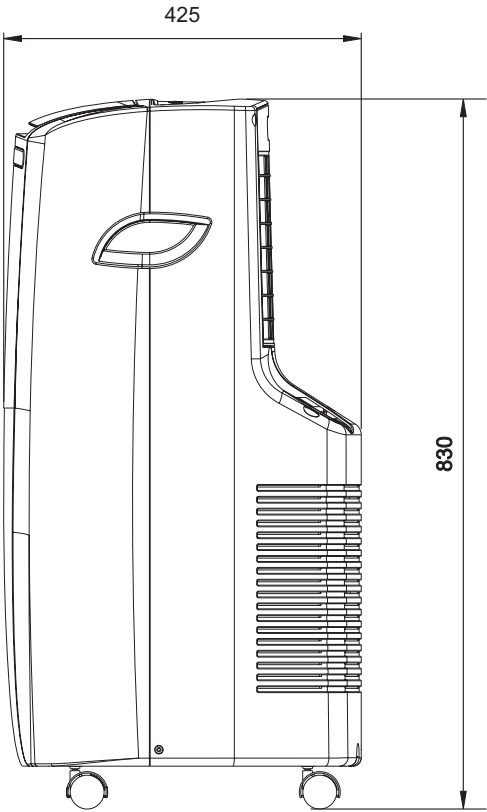
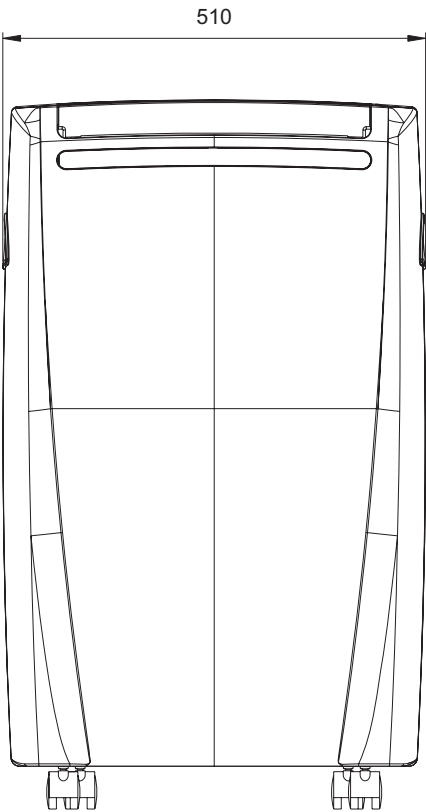

Operation

Control Panel

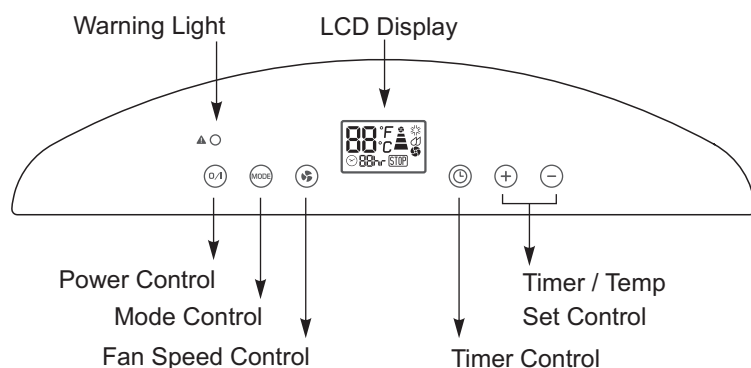

Indication symbols on LCD :

- | | | | |
|--|---|--|----------------|
| | Cooling mode | | High fan speed |
| | Dehumidify mode | | Med fan speed |
| | Fan only mode | | Low fan speed |
| | Display set temperature | | |
| | Warning light the machine will stop running | | |
| | Display timer setting of auto switch on/off | | |

Power Control

The power control turns the unit on and off.

Warning Light

Condensed water may accumulate in the unit. If the internal tank becomes full, the Warning signal in the LCD Display will light up and the unit will not operate until the unit has been drained.

Mode Control

The Mode Control has 3 settings:

● Cool ● Dehumidify ● Fan

The settings are adjusted with Mode Control button. A light will indicate which setting is currently being used.

• Cooling Mode

When cool mode is selected, "❄" will show in the LCD Display. During the cooling mode the air is cooled and hot air is exhausted to the outside through the exhaust tube. Adjust fan speed and air temperature to suit your desired comfort level.

Note : The air exchange hoses must vent outside the room when using cool mode.

• Dehumidify Mode

When Dehumidify mode is selected, "☁" will show in the LCD Display. Air is dehumidified as it passes through the unit, without being in full cooling mode. If room temperature is higher than 25°C, fan speed can be adjusted; otherwise fan speed is fixed to "Low".

Note : If the unit is to be used as a dehumidifier, do not connect the exhaust hose let the warm air return to the room. Continuous drainage is then necessary.

• Fan Mode

When fan mode is selected, "♂", "♀" or "♂" will be shown in the LCD Display, air is circulated throughout the room with no cooling.

Note: unit does not need to be vented in Fan mode

Fan Speed Control

The Fan Speed Control has 3 settings: High, Medium, and Low.

Timer

Auto turn off :

With machine in running mode, press timer button for setting timer control. Press "+" or "-" to select number of hours you would like the unit to run before it automatically shuts off.

Auto turn on :

With machine in stand by mode, press timer button for setting timer control. Press "+" or "-" to select number of hours before the unit automatically starts running in airconditioning mode.

Note : The time is adjustable between 1~24 hours.

Temperature controls

- Used for adjusting the thermostat.
 - The default display is room temperature.
 - In cooling mode, when "+" or "-" button is pressed, the set temperature is displayed and may be adjusted. After 15 seconds the display will revert back to room temperature. Temperature is only adjustable in cool mode.
- Note : By pressing both "+" / "-" buttons at the same time for more than 3 seconds, the display will toggle between Celsius and Fahrenheit.**

After switching the air conditioner off, you must wait 3 minutes before switching it back on again.

Operation

Air Conditioner Remote Control

The functions work the same as your air conditioner's touch controls.
All key function can be accessed from the remote control.

CONTROL PANEL

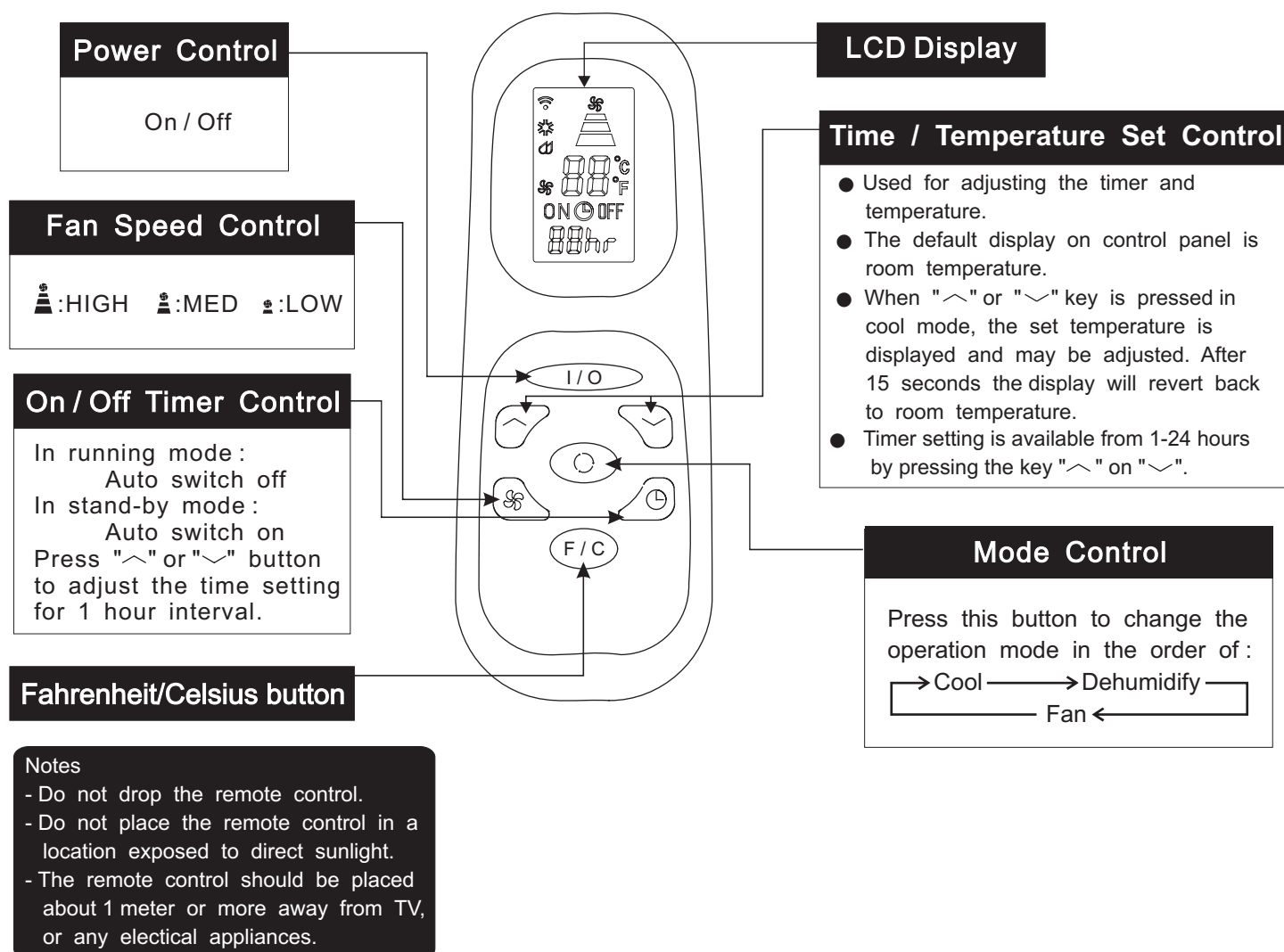

Battery replacement : Remove the cover on the back of the remote control and insert the batteries with the (+) and (-) poles pointing in the proper direction.

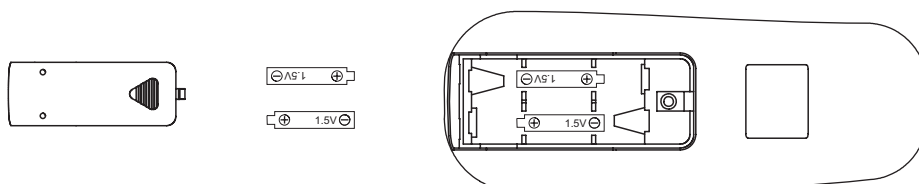

CAUTION

Use only AAA or IEC R03 1.5V batteries.

Remove the batteries if the remote control is not used for a month or longer.

Do not attempt to recharge the supplied batteries.

All batteries should be replaced at the same time, do not mix old battery .

Do not dispose of the batteries in a fire as they may explode.

Installation instructions

Connect exhaust hose assembly to the back of the unit. Extend hose to desired length and locate the exhaust nozzle through the window for ventilation.

EXHAUST DUCT SET ASSEMBLY AND INSTALLATION

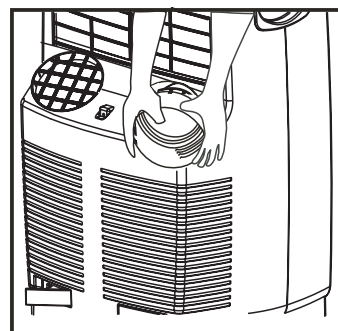
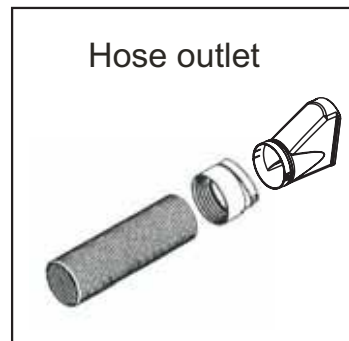
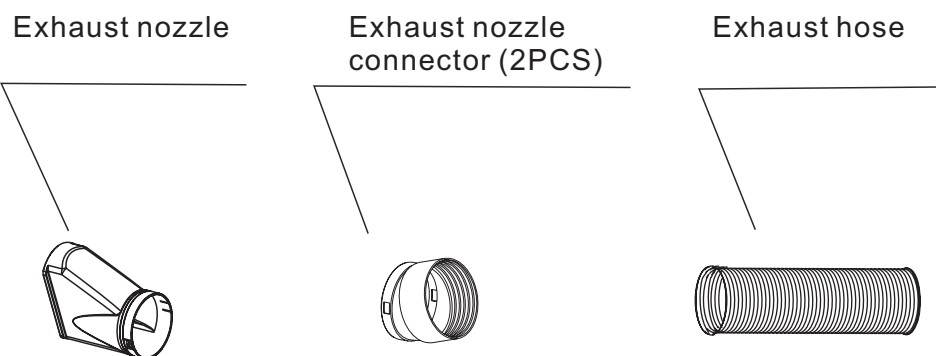

1. Insert both ends of the Exhaust hose into the two Exhaust nozzle connectors by twisting anti-clockwise until it stops.
2. Fix one of the nozzle connector onto the rear outlet of the unit. This is achieved by sliding the nozzle connector of the hose downwards over the exhaust outlet of the unit ensuring that the lugs on the nozzle connector are engaged with the grooves on the connector of unit.
3. Fix another exhaust nozzle to the exhaust nozzle connector.
4. Extend the Exhaust hose and close the window as far as possible trapping the exhaust nozzle as below shown.

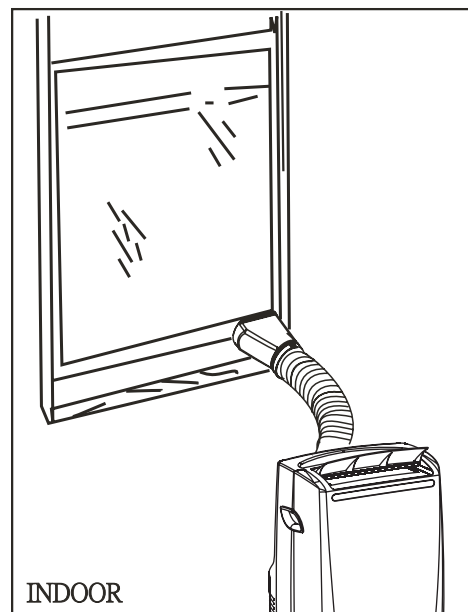
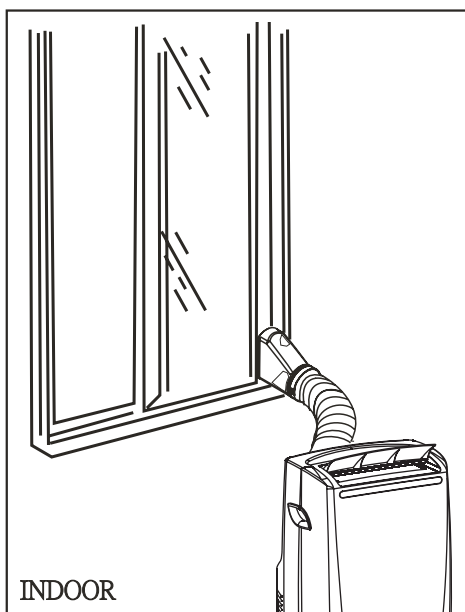
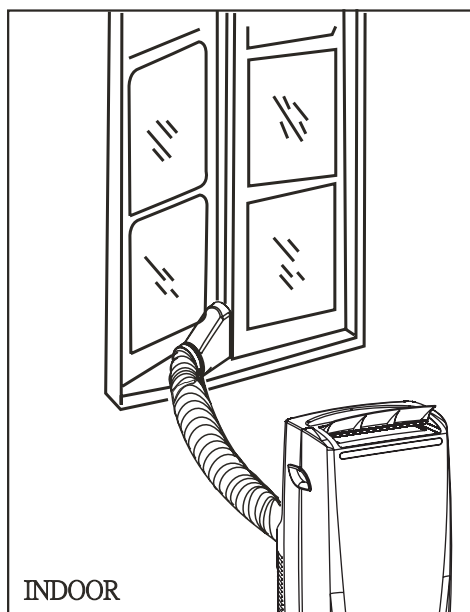
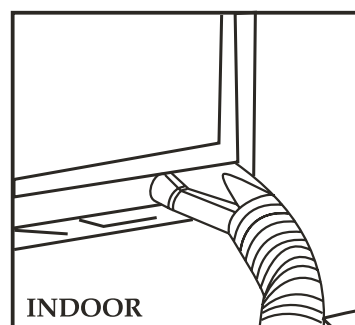

Installation instructions

AIR CONDITIONING WITH INSTALLATION

If required, your appliance can also be installed semi permanently (Fig.1)

Proceed as follows :

- Drill a hole in an outside wall or through a window pane.
Respect the height and dimensions of the hole given in Fig. 2.
- Fit the flange accessory fixture provided in the hole.
- Fit the exhaust hose in the housing at the back of the appliance.
- Insert the other end of the exhaust hose to the flange previously fit on the wall as shown in Fig.

When the hose is not in use, place the cap for connector to cover the hole.

NOTE :

When installing the air conditioner semi permanently, you should leave a door slightly open (as little as 1cm) to guarantee sufficient ventilation.

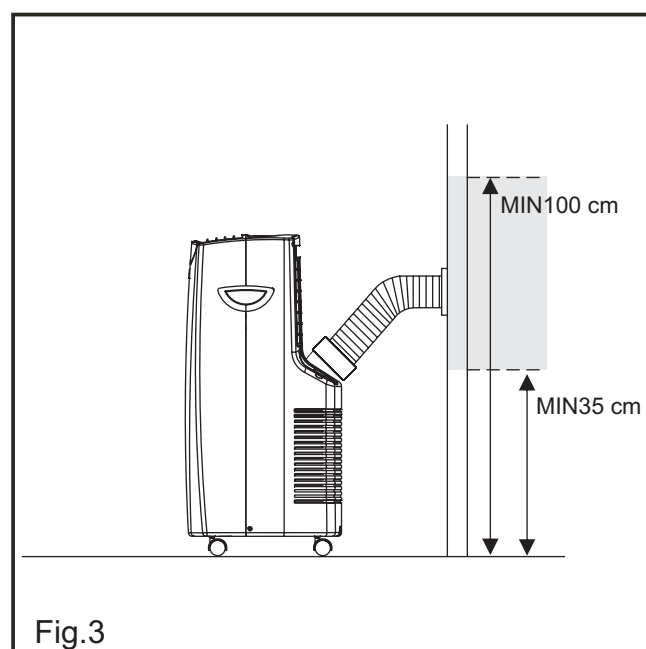
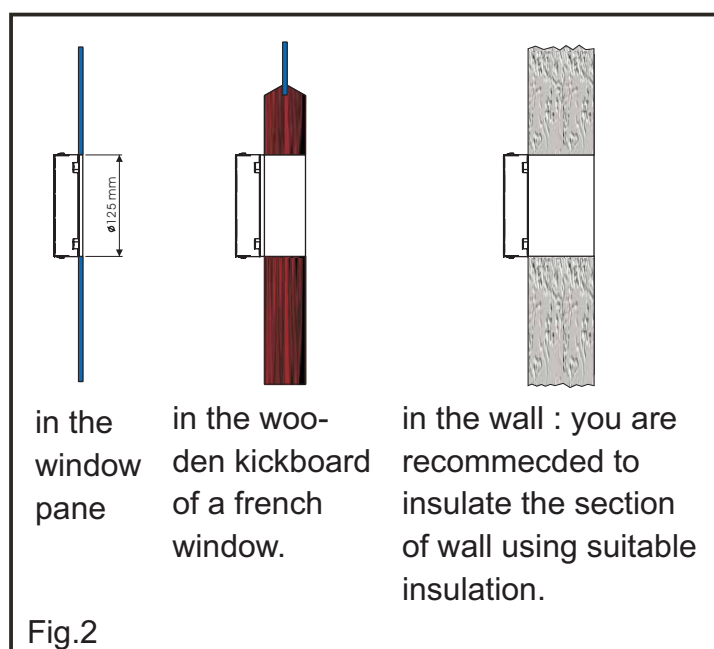
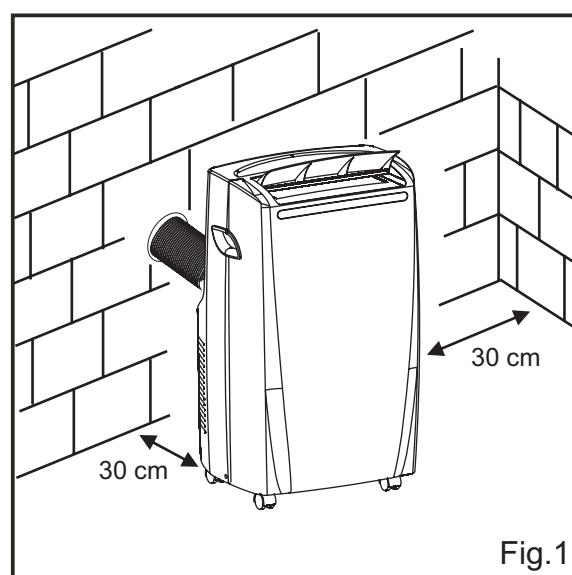
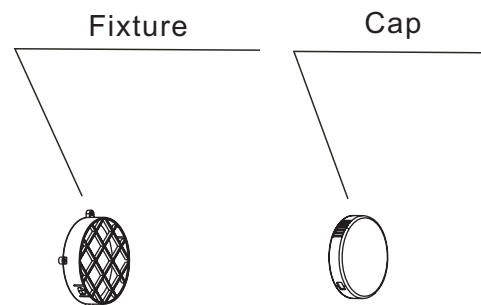

Troubleshooting

The following cases may not always be a malfunction, please check it before asking for service.

Trouble	Analysis
Does not run	<ul style="list-style-type: none">· If the protector trip or fuse is blown, please wait for.· Please wait for 3 minutes and start again, protector device may be preventing unit from working.· If batteries in the remote control are used up.· If the plug is not properly plugged.
Stops running during operation	<ul style="list-style-type: none">· If the set temperature is close to room temperature, you can lower the set temperature.· Air outlet be blocked by obstacle. Take the obstacle away.
Runs but does not cool	<ul style="list-style-type: none">· If the door or window open.· If there is other heater appliance work nearby, like heater or lamp, etc...· The air filter is dirty, please clean it.· Air outlet or intake be blocked.· Set temperature is too high.
Does not run and water full indicator is lit	<ul style="list-style-type: none">· Drain the water into a prepared container by the drainage pipe on the rear panel of the unit. If it still doesn't work, please consult a qualified technician.

Troubleshooting

Appliance maintenance

1 Cut off the power supply

Turn off the appliance first before disconnecting from power supply



2 Wipe with a soft ant dry cloth.

If unit is quite dirty use a mild detergent and damp cloth.



3 Never use volatile substance such as gasoline or polishing powder to clean the appliance.



4 Never sprinkle water onto the main unit.



Dangerous!
Electric shock!

Air filter maintenance

It is necessary to clean the air filter after using it for about 100 hours. Clean it as follows:

1 Stop the appliance and remove the air filter.

Stop the appliance first, then pull back the air filter.

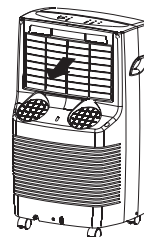

2 Clean and reinstall the air filter

If the dirt is conspicuous, wash it with a solution of detergent in lukewarm water. After cleaning, dry it in a shaded and cool place, then reinstall it...



3 Clean the air filter every two weeks If the air conditioner operates in an extremely dusty environment.

Maintenance after using

- 1.If the appliance will not be used for a long time, be sure to pull out the rubber plug of the drain port underside, in order to drain the water.
- 2.Before storing away run the unit in fan mode only for few hours to dry any moisture on the coils to prevent mold.
- 3.Stop the appliance and pull out the power supply plug, then take out the batteries of remote controller and keep it in a safe place.
- 4.Clean the air filter and reinstall it.
- 5.Remove the air hoses and keep them in a safe place, and cover the hole tightly.

Specifications

- Figures noted, in the contents are for reference only; variation may result due to application in different countries or regions, and shall be based on the bast of practical operation.

Model	AELIA 9 A	AELIA 12 A
Description of product	Air Conditioner	
Voltage/Frequency	AC 220-240V ~ 50Hz	
Input power (Cooling)	1000 W	1400 W
Cooling capacity	2.6 kW	3.5 kW
Dehumidifying capacity	1.6 L/hour	2.0 L/hour
Coolant	R-410A	
Timer	24 hour	
Dimensions (W) X(H)X (D)	510 X 830 X 425 mm	
Weight	34 kg	37 kg

Do not vent R410A into atmosphere: R410A is a fluorinated greenhouse gas, covered by Kyoto Protocol, with a Global Wamring Potential (GWP) = 1975.

"Waste electrical products should not be disposed of with household waste. Please recycle where facilities exist. Check with your local authority or retailer for recycling advice."



Installation instructions

Connect exhaust hose assembly to the back of the unit. Extend hose to desired length and locate the exhaust nozzle through the window for ventilation.

Accessories Include

Single hose:

Exhaust nozzle 1 pc
Exhaust nozzle connector ... 2 pcs
Exhaust hose 1 pc
Fix ture 1 pc
Cover 1 pc

Double hose:

Exhaust nozzle 2 pcs
Exhaust nozzle connector ... 4 pcs
Exhaust hose 2 pcs
Fix ture 2 pcs
Cover 2 pcs

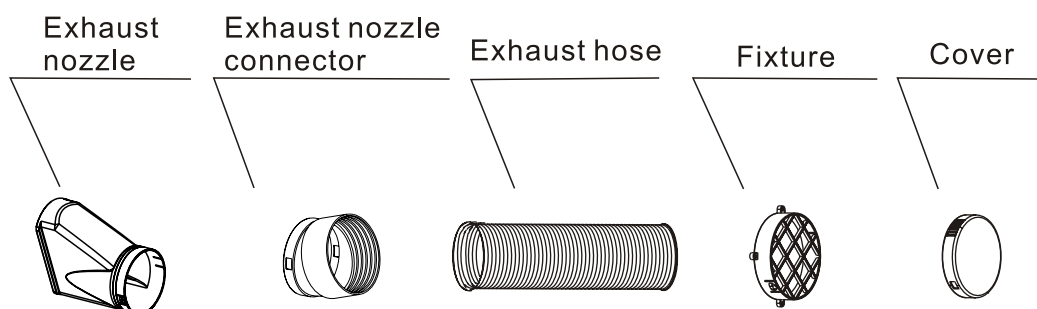

EXHAUST DUCT SET ASSEMBLY AND INSTALLATION

1. Insert both ends of the Exhaust hose into the two Exhaust nozzle connectors by twisting anti-clockwise until it stops.
2. Fix one of the nozzle connector onto the rear outlet of the unit. This is achieved by sliding the nozzle connector of the hose downwards over the exhaust outlet of the unit ensuring that the lugs on the nozzle connector are engaged with the grooves on the connector of unit.
3. Fix another exhaust nozzle to the exhaust nozzle connector.
4. Extend the Exhaust hose and close the window as far as possible trapping the exhaust nozzle as below shown.

☉ **Same installation is applicable for the second hose of double hose unit.**

Hose outlet

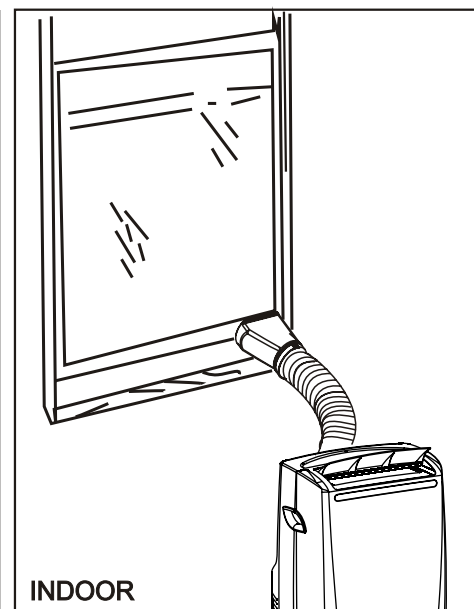
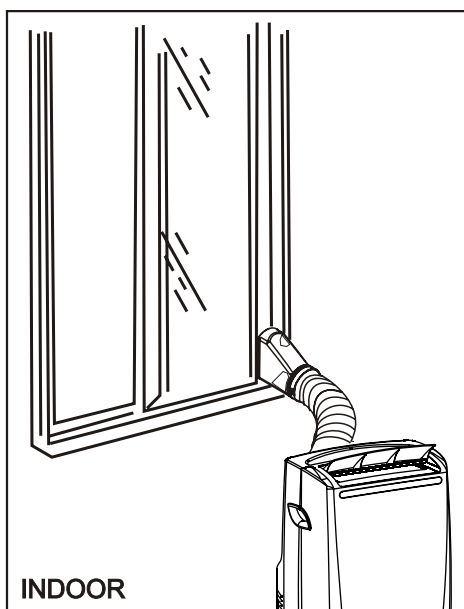
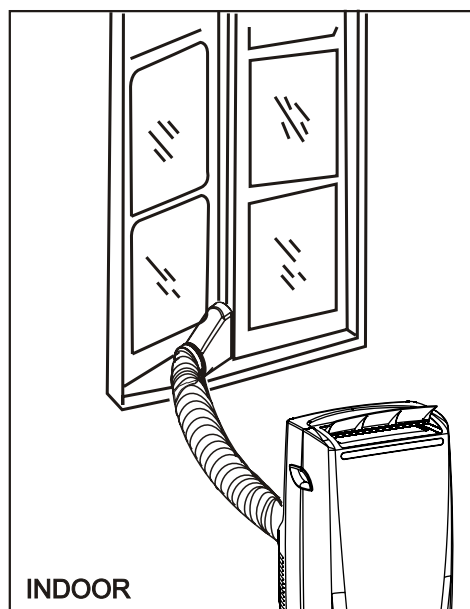
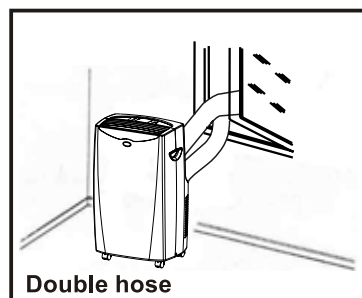
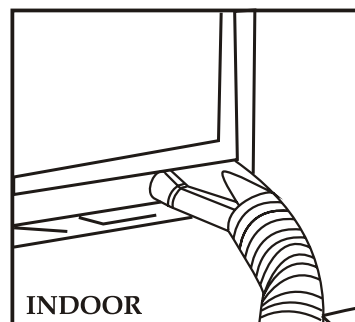
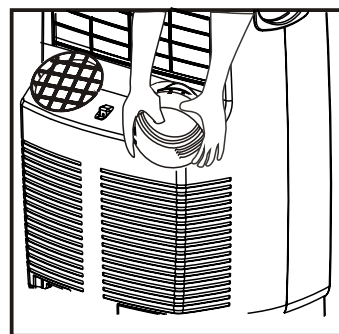
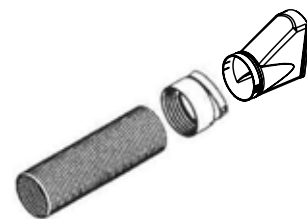

Installation instructions

AIR CONDITIONING WITH INSTALLATION

If required, your appliance can also be installed semi permanently (Fig.1)

Proceed as follows :

- Drill a hole in an outside wall or through a window pane.
Respect the height and dimensions of the hole given in Fig. 2.
- Fit the flange accessory fixture provided in the hole.
- Fit the exhaust hose in the housing at the back of the appliance.
- Insert the other end of the exhaust hose to the flange previously fit on the wall as shown in Fig.3.

When the hose is not in use, place the cap for connector to cover the hole.

NOTE :

When installing the air conditioner semi permanently, you should leave a door slightly open (as little as 1cm) to guarantee sufficient ventilation.

